

Cleaning the
nexus
ON A GRAVITY FED SYSTEM

Follow these cleaning instructions if the Nexus is installed on a gravity-fed setup when a **bottom drain** in the pond **delivers** water into your Nexus.

EVOLUTION
AQUA
INNOVATION IN WATER



Switch the circulation pump **off**.
Wait for 1 minute.



Insert the inlet slide plate.



Insert the cleaning pipe into the centre of the Eazy.



Open air valve to the **inner chamber**.



Close the air valve to the **outer chamber**.



Allow the K1 Micro in the Eazy to **agitate** for **5 minutes**.



Open the larger waste valve and wait for the **inner chamber** to empty.

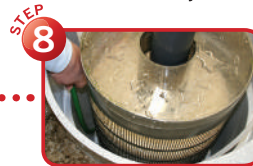

At this stage you may want to **hose down** any debris from underneath the Eazy.



Close the waste valve.



Open the air valve to the **outer chamber**.



Close the air valve to the **inner chamber**.



Remove the inlet slide plate and wait until the **inner chamber** has filled with water.



Once **inner chamber** has filled, **remove** the cleaning pipe.



Switch the circulation pump **on**.

Steps 2 to 13 should be repeated until the Eazy is clean.

GRAVITY FED CLEANING INSTRUCTIONS – NEXUS 220 & 320